

**4.75 IN/120.65MM
 TORPEDO DIA.**

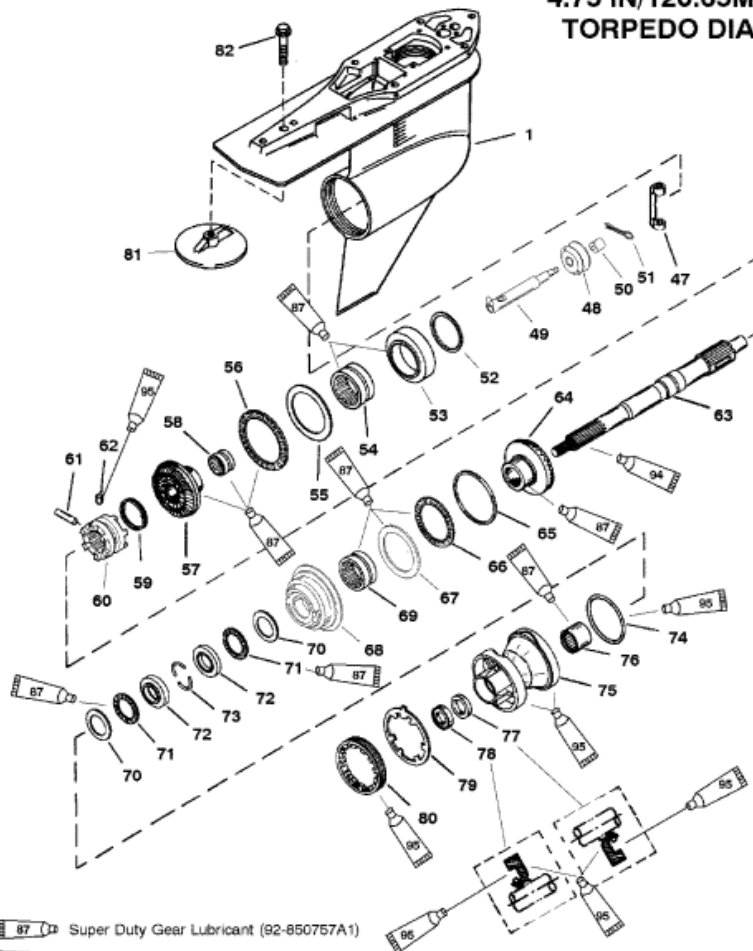

- Super Duty Gear Lubricant (92-850757A1)
- Anti-Corrosion Grease (92-850735A1)
- 2-C w/Teflon (92-850736A1)

Parts List						
Ref	Class	Part	Description	Qty	Comment	Footnote
1	1623	857113T 3	GEAR HOUSING	1	(BASIC-BLACK)	
47		823903	SHIFT CRANK	1		
48		19755A 7	SHIFT SPOOL	1		
49		NSS	SPOOL	1		4
50		NSS	SLEEVE	1		4
51		NSS	COTTER PIN	1		4
52	15	44491A 1	SHIM SET	AR		9
53		828830A 2	BEARING ADAPTOR ASSEMBLY	1		
54	31	814653	ROLLER BEARING	1		
55	12	815481	THRUST WASHER	1		
56	31	815480	THRUST BEARING	1		
57	43	828696A 2	REVERSE GEAR	1	(1.75:1 - 12/21)	
58	31	15844	ROLLER BEARING	1		
59	24	30893	SPRING	1		
60	52	854735T	SLIDING CLUTCH	1		
61	17	30632	CROSS PIN	1		
62	17	828356	DETENT PIN	1		
63	44	824111	PROPELLER SHAFT	1		
64	43	828695A 1	FORWARD GEAR	1	(1.75:1 - 12/21)	
65	23	17615 14	SPACER SHIM	AR	(.206 IN.)	9
65	23	17615 15	SPACER SHIM	AR	(.208 IN.)	9
65	23	17615 16	SPACER SHIM	AR	(.210 IN.)	9
65	23	17615 17	SPACER SHIM	AR	(.212 IN.)	9
65	23	17615 18	SPACER SHIM	AR	(.214 IN.)	9
65	23	17615 19	SPACER SHIM	AR	(.216 IN.)	9
65	23	17615 20	SPACER SHIM	AR	(.218 IN.)	9
65	23	17615 21	SPACER SHIM	AR	(.220 IN.)	9
65	23	17615 22	SPACER SHIM	AR	(.222 IN.)	9
65	23	17615 23	SPACER SHIM	AR	(.224 IN.)	9
65	23	17615 24	SPACER SHIM	AR	(.226 IN.)	9
65	23	17615 25	SPACER SHIM	AR	(.228 IN.)	9
65	23	17615 26	SPACER SHIM	AR	(.230 IN.)	9
66	31	815480	ROLLER BEARING	1		
67	12	815481	THRUST RING	1		
68		828831A 3	BEARING ADAPTOR ASSEMBLY	1		
69	31	814653	ROLLER BEARING	1		
70	12	18448	THRUST WASHER	2		
71	31	15842	THRUST BEARING	2		
72		818291 1	THRUST RACE	2		
73		814605	KEEPER	2		
74	25	21524	O-RING	1		7